

WSB PROJECT NO.:
01987-680

SCALE: AS SHOWN
DESIGN BY: JMS / KAH
PLAN BY: TOR
CHECK BY: GCT

REVISIONS	
NO.	DESCRIPTION

I HEREBY CERTIFY THAT THIS PLAN, SPECIFICATION, OR REPORT WAS PREPARED BY ME OR UNDER MY DIRECT SUPERVISION AND THAT I AM A DULY LICENSED PROFESSIONAL ENGINEER UNDER THE LAWS OF THE STATE OF MINNESOTA.

MORGAN A. DAWLEY
DATE: 7-14-2021 LIC. NO.: 44178

LEGEND

- GRADING LIMITS
- PROPOSED CONTOUR
- EXISTING CONTOUR
- PROPOSED SPOT ELEVATION
- EXISTING SPOT ELEVATION (MEET & MATCH EXISTING)
- INLET PROTECTION. (4 EACH) (SEE 1/CG500)
- SILT FENCE (SEE 2/CG500)
- ROCK CONSTRUCTION ENTRANCE. (800 SF) (SEE 4/CG500)

GRADING NOTES

- GRADING ACTIVITY WHICH BLOCKS TRAFFIC OF ANY STREET, ALLEY, OR DRIVE IS SUBJECT TO APPROVAL BY THE CITY.
- CONTRACTOR SHALL STOP WORK IMMEDIATELY AND NOTIFY THE ENGINEER AND OWNER IF CONTAMINANTS ARE FOUND IN THE EXISTING SOILS.
- PROVIDE POSITIVE DRAINAGE AT ALL TIMES WITHIN THE CONSTRUCTION AREA. DO NOT ALLOW WATER TO POND IN EXCAVATION AREAS, AND MAINTAIN ALL EXISTING DRAINAGE PATTERNS.
- THE CONTRACTOR SHALL BE RESPONSIBLE TO COMPLY WITH ALL OSHA REGULATIONS IN THE EXECUTION OF WORK UNDER THIS CONTRACT.
- THE CONTRACTOR SHALL APPLY FOR A CITY OF TONKA BAY GRADING PERMIT BEFORE STARTING WORK. THE INSPECTOR AND THE CITY OF TONKA BAY PUBLIC WORKS DEPARTMENT SHALL BE NOTIFIED BY THE CONTRACTOR 48 HOURS BEFORE START OF CONSTRUCTION. NO WORK MAY BEGIN UNTIL THE PERMIT HAS BEEN RECEIVED AND THE CONTRACTOR MUST COMPLY WITH THE TERMS OF THE PERMIT.
- ALL NON-PAVED AREAS SHALL RECEIVE A FOUR-INCH (4") LAYER OF TOPSOIL.
- THE CONTRACTOR SHALL ADJUST TO GRADE ALL MANHOLE STRUCTURES AND APPURTENANCES THAT FALL WITHIN THE LIMITS OF THIS CONTRACT. THE CONTRACTOR SHALL KEEP ALL SAID EXISTING UTILITIES AND THEIR APPURTENANCES FREE OF DEBRIS AND OPERABLE AT ALL TIMES DURING CONSTRUCTION.

STORM SEWER NOTES

- VERIFY EXISTING INVERTS PRIOR TO CONSTRUCTION. IT IS ASSUMED THAT ALL EX. STORM SEWER IS 5' OR SHALLOWER.
- INSTALL CATCH BASIN MANHOLE ST-01 WITH 4' SUMP. NEENAH R-1792 CASTING OR EQUAL WITH OPEN GRATE. INSTALL CONCRETE PAD SUCH THAT EDGE OF CONCRETE IS 3" HIGHER THAN RIM ELEVATION.
- INSTALL CATCH BASIN MANHOLE ST-02 WITH NEENAH R-1792 CASTING OR EQUAL WITH OPEN GRATE.

PARKING LOT RECONSTRUCTION & EXPANSION
CITY OF TONKA BAY

GRADING, DRAINAGE, & EROSION CONTROL PLAN

CG100B

K:\01987-680\Cad\Plan\01987-680-C-03-GRAB-DRAIN-EGOS-CUTTR-PLAN_Alt_2.dwg 9/17/2021 8:24:41 AM

NO.	DATE	DESCRIPTION

I HEREBY CERTIFY THAT THIS PLAN, SPECIFICATION, OR REPORT WAS PREPARED BY ME OR UNDER MY DIRECT SUPERVISION AND THAT I AM A DULY LICENSED PROFESSIONAL ENGINEER UNDER THE LAWS OF THE STATE OF MINNESOTA.

MORGAN A. DAWLEY
DATE: 7-14-2021 LIC. NO.: 44178

**PARKING LOT
RECONSTRUCTION &
EXPANSION**
CITY OF TONKA BAY

**FILTRATION BASIN
PLAN**

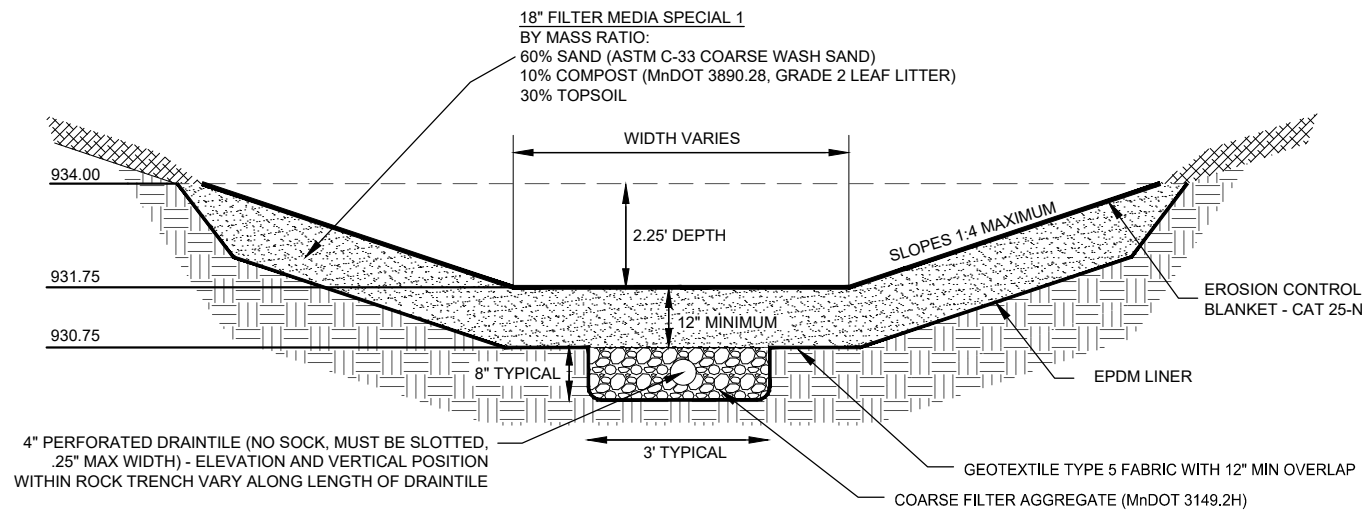

FILTRATION BASIN 1 DETAIL
NOT TO SCALE

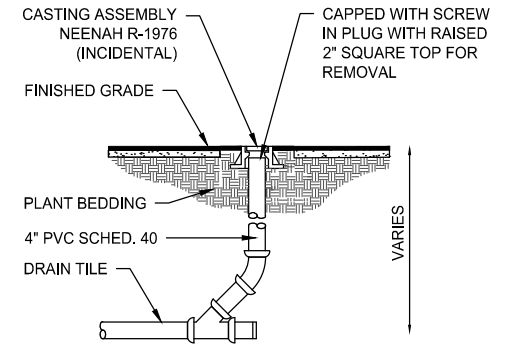

NOTES:
1. BENDS AND RISER TO BE SAME SIZE AS DRAINTILE

DRAINTILE CLEANOUT
NOT TO SCALE

- LEGEND**
- FILTRATION BASIN GRADING LIMITS
 - PROPOSED CONTOUR
 - EXISTING CONTOUR
 - PROPOSED SPOT ELEVATION
 - EXISTING SPOT ELEVATION (MEET & MATCH EXISTING)
 - 4" PERF DRAINTILE

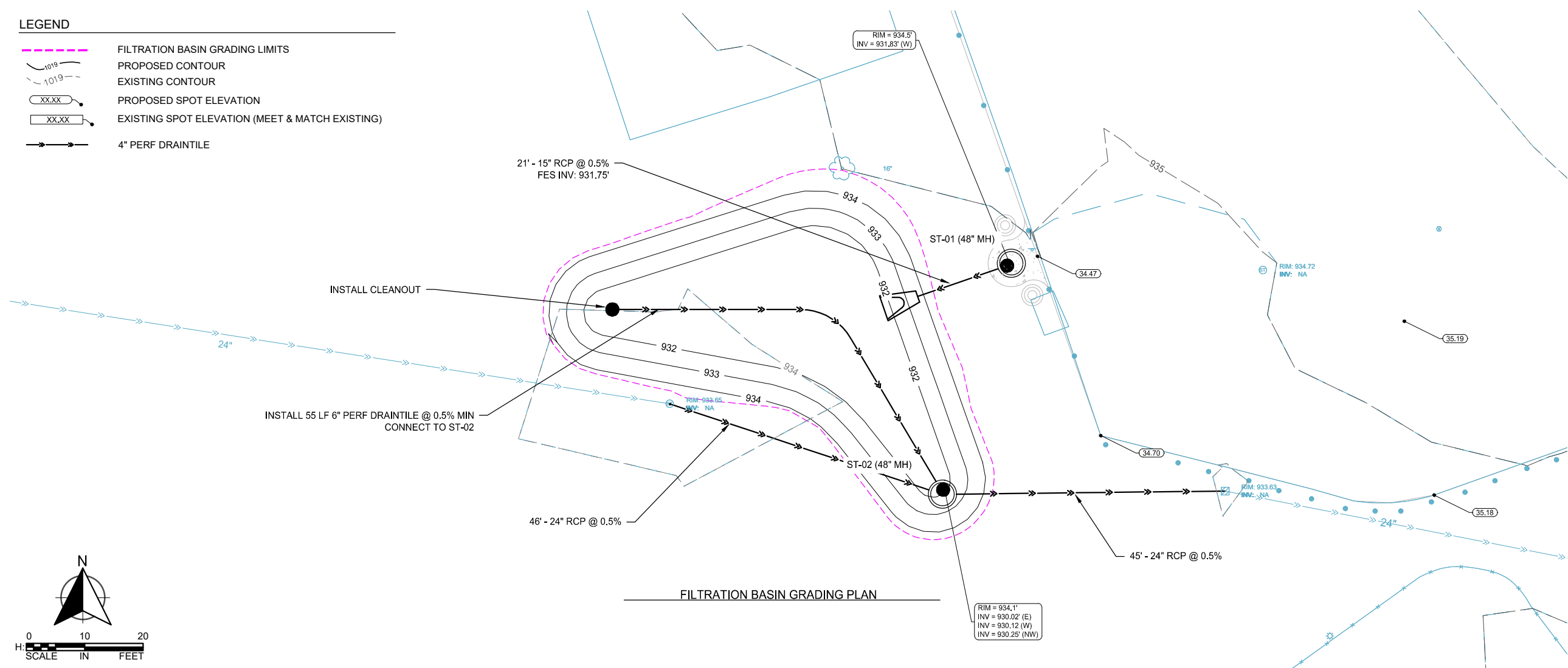

FILTRATION BASIN GRADING PLAN

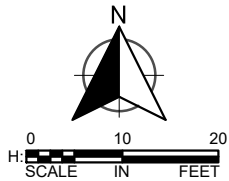

K:\101987-680\Cad\Plan\101987-680-C-03-GRAB-DRAIN-EIOS-CUTR-PLAN_Alt 2.dwg 9/17/2021 8:35:21 AM