

PLOTTED/REVISED: 14-FEB-2019

DISTRICT #: Metro
PLOT NAME: d2714145_drf2
FILENAME: Projects\DM_R05\012714145\Design\Plan\Sheets\d2714145_drf2.dgn

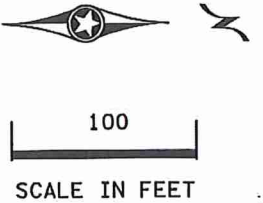
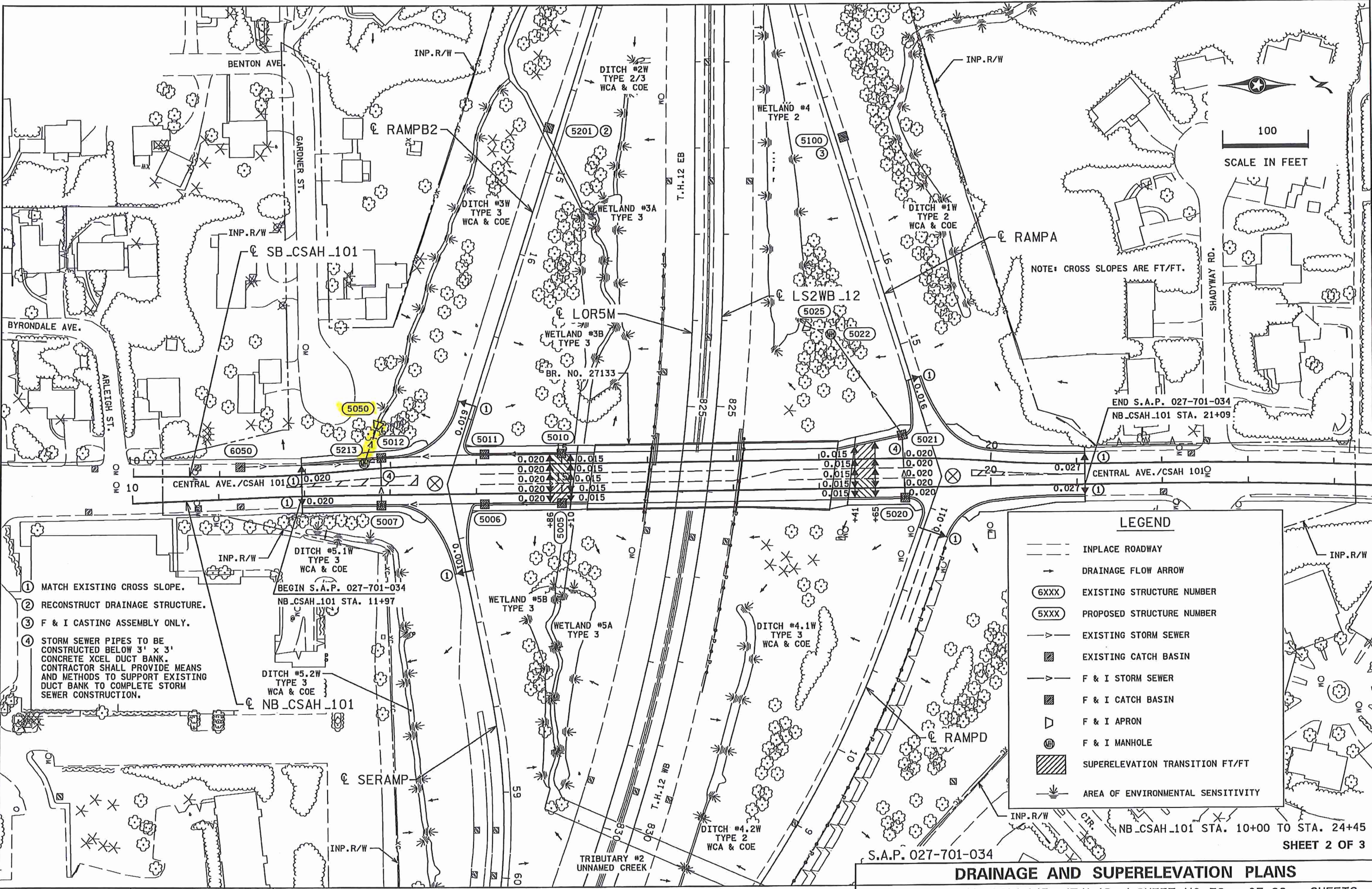

NOTE: CROSS SLOPES ARE FT/FT.

END S.A.P. 027-701-034
NB_CSAH_101 STA. 21+09

LEGEND

- INPLACE ROADWAY
- DRAINAGE FLOW ARROW
- EXISTING STRUCTURE NUMBER
- PROPOSED STRUCTURE NUMBER
- EXISTING STORM SEWER
- EXISTING CATCH BASIN
- F & I STORM SEWER
- F & I CATCH BASIN
- F & I APRON
- F & I MANHOLE
- SUPERELEVATION TRANSITION FT/FT
- AREA OF ENVIRONMENTAL SENSITIVITY

- ① MATCH EXISTING CROSS SLOPE.
- ② RECONSTRUCT DRAINAGE STRUCTURE.
- ③ F & I CASTING ASSEMBLY ONLY.
- ④ STORM SEWER PIPES TO BE CONSTRUCTED BELOW 3' x 3' CONCRETE XCEL DUCT BANK. CONTRACTOR SHALL PROVIDE MEANS AND METHODS TO SUPPORT EXISTING DUCT BANK TO COMPLETE STORM SEWER CONSTRUCTION.

BEGIN S.A.P. 027-701-034
NB_CSAH_101 STA. 11+97

S.A.P. 027-701-034
NB_CSAH_101 STA. 10+00 TO STA. 24+45
SHEET 2 OF 3

DRAINAGE AND SUPERELEVATION PLANS